



- ULTRA SERIES -  
**PRESSURE FILTER/UV CLARIFIERS**



# **INSTRUCTION MANUAL**

**PondMAX™ USA**

P.O. Box 341  
San Leandro, CA 94577

Toll Free 888.868.1185  
Email: [info@PondMAX™.com](mailto:info@PondMAX™.com)  
[www.PondMAX™.com](http://www.PondMAX™.com)

# PondMAX

## - ULTRA SERIES -

# PRESSURE FILTER/UV CLARIFIERS

	PF750	PF1200	PF2400	PF3600
<b>MAXIMUM POND SIZE - WITHOUT FISH - SHADED (GAL)</b>	750	1200	2400	3600
<b>MAXIMUM POND SIZE - WITH FISH - FULL SUN (GAL)</b>	350	600	1200	1800
<b>MAXIMUM FLOW (GPH)</b>	1000	1200	2400	3200
<b>FILTER CANISTER CAPACITY (GAL)</b>	4	5	6.5	9
<b>HOSETAIL INLET/OUTLETS (INCH)</b>	.75/1/1.25	.75/1/1.25/1.5	.75/1/1.25/1.5	.75/1/1.25/1.5
<b>WITH UV-C OPTION</b>				
<b>VOLTS</b>	115	115	115	115
<b>ULTRAVIOLET CLARIFIER (WATTS)</b>	9	13	18	24
<b>CABLE LENGTH (FT)</b>	10	16	16	16

**WELCOME TO THE WORLD OF PONDMAX™. YOU MADE THE RIGHT CHOICE INVESTING IN THIS QUALITY PRODUCT. THANK YOU AND ENJOY.**

**BEFORE USING THIS PRODUCT, PLEASE READ THESE INSTRUCTIONS OF USE CAREFULLY AND MAKE YOURSELF FULLY FAMILIAR WITH THE UNIT. PLEASE KEEP THESE INSTRUCTIONS IN A SAFE PLACE FOR FUTURE REFERENCE.**

## DESCRIPTION AND FEATURES

Your PondMAX™ pond filter has been manufactured with advanced technology to provide you with the best quality filter for your pond or waterfeature.

- A pressure indicator lets you know when the pressure in the filter increases indicating that the filter foams are getting blocked and requires cleaning .
- A large canister and high surface area bio media ensures maximum biological filtration. In normal operation the water enters the filter and is forced around the edge of the filter canister creating a vortex where larger particles are precipitated through gravity. The water then passes through the different density foam sponges, the higher density foam allows the water to pass through slower promoting colonization of Nitrosomonas bacteria and the lower density foam allows the water to pass through faster promoting colonization of

Nitrobacter bacteria. The water is then passed by the Ultraviolet light (if applicable) which inhibits bacteria and algae growth and returns back into the pond.

- An integral backwash function back-flushes the filter and compresses the foam sponge media.
- (With UV-C Option) An Ultra Violet Clarifier incorporated into the filter helps maintain crystal clear water.

## INSTALLATION

1. (With UV-C Option) Have a licensed electrician install a weatherproof power point near to the pond or water feature (within the cable length of the filter).
2. Identify a suitable location for your new pressure filter. The pressure filter can be used in between a pump and a water feature or waterfall. The filter can also be partially buried to help disguise it in your garden. It is important to return

the clean filtered water from your filter to the opposite end of your pond to where the pump suction is located.

3. Connect anti-kink hose or poly tubing from your pump to the inlet of the filter. Your filter comes with different sized fittings to connect to the inlet, outlet and back-flush outlet. Make sure to cut off the hose tails that are smaller than the hose or tube size being used. Eg: If using 1-1/2" hose, cut off the smaller sections. Please use the largest size tubing possible. We recommend using PondMAX™ hose clamps for a leak free connection.
4. Connect tubing from the outlet of the filter back into your pond at the opposite end to where you are pumping from. You can have the outlet of the filter running into a waterfall. You only need to connect tubing to the back-flush outlet if you require the dirty water from the backwash to be diverted to a specific location.
5. If the flow from your pump is greater than the recommended max flow, you must reduce the flow, or bypass some of the flow with a Y fitting. The pressure must not exceed 6.5 PSI or 15 feet of head.
6. (With UV-C Option) Turn your pump on and then plug in the UV-C unit on the filter, if applicable. The UV-C unit should not be turned on if there is no water flowing past the UV-C lamp.
7. You can help boost the biological function of your filter with PondMAX™ Bacteria. Now sit back, relax and enjoy a clean and healthy pond.

## **MAINTENANCE**

**(With UV-C Option)** Disconnect power cord from the power supply before performing maintenance. Never lift the filter by the power cord.

**(With UV-C Option)** The UV-C lamp must be checked regularly and should be replaced every 12 months.

**(With UV-C Option)** To visually check the lamp, look through the clear UV-C indicator on the top of the filter and if the light is working you will see a purple glow.

**(With UV-C Option)** The power cord cannot be replaced. If the cord is damaged, UV-C assembly must be replaced.

**The filter must be operational 24 hours every day for it to function effectively.**

## **USING THE BACKWASH**

1. Make sure to always power off your pump before performing backwash on your filter. Once pump is off, turn the ball valve on the backwash outlet to open.
2. Now turn the backwash (arrow shaped) dial on the top of the filter to "clean" mode (the arrow will face towards the ball valve backwash outlet).
3. Next power the pump back on. The water from the normal outlet will now come out the backwash outlet.
4. Turn the cleaning crank handle clockwise on the filter several times or until the water exiting the backwash outlet becomes clean. Cleaning crank handle helps mechanically agitate debris on filter pads inside the filter.
5. Once backwash is done, power pump back off again.
6. With pump off, turn the backwash function dial on the top of the filter back to "filter" mode and close the valve on the backwash outlet.
7. Now that the backwash is complete, power the pump back on. Last, sit back and enjoy your watergarden.

## **FULL DISASSEMBLE AND RINSE**

1. (With UV-C Option) Turn off your pump and disconnect the power cord from any electrical source. Undo the threaded inlet and outlets from the filter, unclip the lid clamp and carefully remove the lid.
2. Take care not to lose or damage the O-ring seal. Unscrew the clear locking screw at the bottom of the filter sponge layers (or the black base plate on PF2400 and PF3600 models). Undo the screw that holds the rod in place and remove the base plate.
3. Now remove the foam sponge rings from off the centre core and rinse them in dechlorinated water or pond water. Using dechlorinated water ensures the chlorine in normal tap water does not kill the beneficial bacteria living in your filter media. Be sure to thoroughly squeeze the sponges to remove sludge.

4. Remove the high efficiency bio media ring (in PF2400 and PF3600 Models only) from the bottom of the filter canister and only remove any excess sludge from the biospheres. You should not remove all of this brown matter as this is the beneficial bacteria which is essential in the breakdown of toxic waste from your pond.
5. Now clean out the canister of your filter and any debris from the lid of the filter and reassemble. First reassemble the partially cleaned bio media ring into the canister and then insert lid with the foam rings installed onto the center core. The Foam rings should alternate from Blue to Yellow.
6. Now put the lid back in place, taking care to locate the O-ring on the canister, then firmly push the lid back onto the canister. Take care to align the locking nut on bottom sponge plate with one of the holes in the biomedica ring. Fasten the lid, clamp in place and reconnect the inlet and outlet.
7. (With UV-C Option) Now plug the pump and filter in, turn on, and sit back and enjoy your watergarden.

## **REPLACING THE LAMP FOR UV-C OPTION**

1. Turn off power supply and remove plug from power outlet. Turn off your pump.
2. Undo the 4 screws on the top of the filter holding the UV-C Assembly in place.
3. Carefully lift up the UV-C Assembly out of the filter lid. Take care not to impact the quartz sleeve on anything – it will break.
4. Undo the quartz sleeve locking collar at the top of the quartz sleeve. Take care not to lose the quartz sleeve o ring and collar.
5. Carefully remove the quartz sleeve from the UV-C Assembly and place in a secure position.
6. You can now access the lamp to replace it. Pull out the old lamp and discard responsibly. Insert a new lamp ensuring it is connected securely.
7. Replace the quartz sleeve onto the UV-C Assembly ensuring the o ring and collar is located properly. Replace and tighten the quartz sleeve locking collar.
8. Replace the UV-C Assembly into the top of the filter ensuring it fits securely. Tighten the 4 screws fixing the Assembly into the filter lid.
9. Turn your pump back on and then reconnect power supply and turn on your filter. You have successfully replaced your UV-C lamp.

## **IMPORTANT SAFEGUARDS**

To guard against injury, basic safety precautions should be observed including, but not limited to the following;

- (With UV-C Option) Do not look at an unshielded UV-C lamp. Ultra Violet light is harmful to your eyes and may cause blindness.
- (With UV-C Option) Always use a properly grounded power supply and protected with a ground fault circuit interrupter (GFCI).
- (With UV-C Option) Always unplug the filter from the power supply when not in use or before performing any maintenance on the pump.
- (With UV-C Option) Never pull the cord to disconnect the plug from the power supply. Grasp the plug and pull to disconnect.
- Do not install or store the filter where it will be exposed to extreme hot or cold temperatures.
- Keep out of reach of children or pets. This appliance should not be used by children without supervision.
- (With UV-C Option) Do not cut the cord as this will result in voiding your warranty.
- (With UV-C Option) Care should be taken to arrange the power cord so that it cannot be accidentally tripped over or pulled.
- Do not attempt to repair the filter yourself. Return to an authorized service centre or place of purchase if a fault occurs (regular maintenance is not considered repair and is required by user).

## **WINTER STORAGE**

In cold winter weather (below freezing), we recommend the filter be removed from operation and drained of all water. The filter must be protected from frost at all times.

2. Turn off power supply to filter (if applicable) by removing plug from power outlet.
3. Turn off your pump.
4. Remove filter from installed location and store in a dry, weather-proof area. It is recommended to keep the filter lid open during winter storage.
5. Once weather permits, reinstall the filter lid securely.
6. Now reinstall filter in its original location and plug filter (if applicable) and pump back in.



## LIMITED WARRANTY

This product is warranted to the initial purchaser to be free of defects in materials and workmanship at the time of initial purchase and for a period of 2 years for PondMAX™ Ultra Series Pressure Filters. Certain filter parts are consumable and must be replaced regularly as part of the ongoing product maintenance and are not covered by this Warranty. These parts are the Biosponges, O’rings, seals and optional UVC lamps inclusive. In the event this product malfunctions within two years from the date of purchase, the sole obligation of PondMAX™ International (hereinafter referred to as PondMAX™ ) will be to repair the unit or replace with an equivalent new or factory refurbished unit at PondMAX™’s discretion, subject to the following conditions:

- The malfunction is proved attributable to a defect in materials or workmanship, including repairs performed under this warranty. Malfunction for any other reason-including but not limited to misuse, negligence, accident, or tampering with parts, incorrect wiring, or improper installation-will not be remedied under this warranty.
- PondMAX™ specifically does not guarantee chemical compatibility, and expressly does not warrant units from any problems caused by chemical attack or failure due to incompatibility of fluid being circulated through filter with filter materials of construction.
- All warranty repairs must be performed by PondMAX™ or a PondMAX™ authorized company. Purchaser must retain the purchase receipt and present it with this certificate as proof of ownership and entitlement to warranty repairs. Unauthorized repairs will not be compensated by PondMAX™, and are not the responsibility of PondMAX™, and if such repairs damage the product, such damages are not remedied under this warranty.
- Purchaser shall bear all shipping, packing and insurance costs and all other costs, excluding labor and parts necessary to effectuate repairs under this warranty.
- This warranty is in lieu of all other express warranties which now or hereafter might otherwise arise with respect to this product. Any and all limited warranties, including the

warranties of merchantability and fitness for particular purpose, shall have no greater duration than the duration period of the express written warranty applicable to this product, and shall terminate automatically the expiration of such duration period. Some states do not allow limitations on how long an implied warranty lasts, so the above limitation may not apply to you. No action shall be brought for breach of any implied or express warranty after one year subsequent to the expiration of the duration period of the express written warranty.

- Incidental and consequential damages caused by malfunction, defect, or otherwise, and with respect to breach of any express or implied warranty, are not the responsibility of PondMAX™, and, to the extent permitted by law, are hereby excluded for property damage, loss of livestock and, to the extent not unconscionable, for personal injury damage. Some states do not allow the exclusion or limitation of incidental or consequential damages, so the above limitation or exclusion may not apply to you.
- This warranty does not apply to any malfunction arising out of any application of this product other than normal use, unless such application is upon request specifically approved in writing by PondMAX™
- The provisions of this warranty are severable and if any provision shall be deemed invalid, the remaining provisions shall remain in full force and effect.
- Rights under this warranty are not assignable without the express prior consent in writing by PondMAX™ and, regardless of the terms of such consent in writing, such assignee shall have no greater rights than his assignor had against PondMAX™.

To facilitate Warranty Registration please complete the enclosed Warranty Registration card and return: by mail to PondMAX™ International, P.O.Box 341, San Leandro, CA 94577 or by email to [info@PondMAX™.com](mailto:info@PondMAX™.com). Customer service can be reached by phone toll free 888.868.1185”.

## EXPLODED VIEW

- 1 Backwash Rinsing Handle
- 2 Pressure Filter Lid
- 3 Hosetail Seal
- 4 Clear Stepped Hosetail - Inlet
- 5 Black Stepped Hosetail - Outlet
- 6 Ball Valve/Stepped Hosetail - Backwash
- 7 Backwash Rinsing Paddles
- 8 Yellow Fine Biosponge
- 9 Blue Coarse Biosponge
- 10 Bottom Sponge Plate and Locking Nut
- 11 Bio Media Ring (Excludes PF750 & PF200)
- 12 Lid Clamp
- 13 Lid O Ring
- 14 Filter Canister
- 15 Clamp Locking Key

## WITH UV-C OPTION

- 1 UV-C Top Cover and Ballast
- 2 UV-C O Ring and Collar Set
- 3 18 Watt UV-C Lamp
- 4 Lamp Cushion
- 5 Quartz Sleeve O Rings
- 6 Quartz Sleeve and Locking Collar

### UV-C OPTION ASSEMBLY

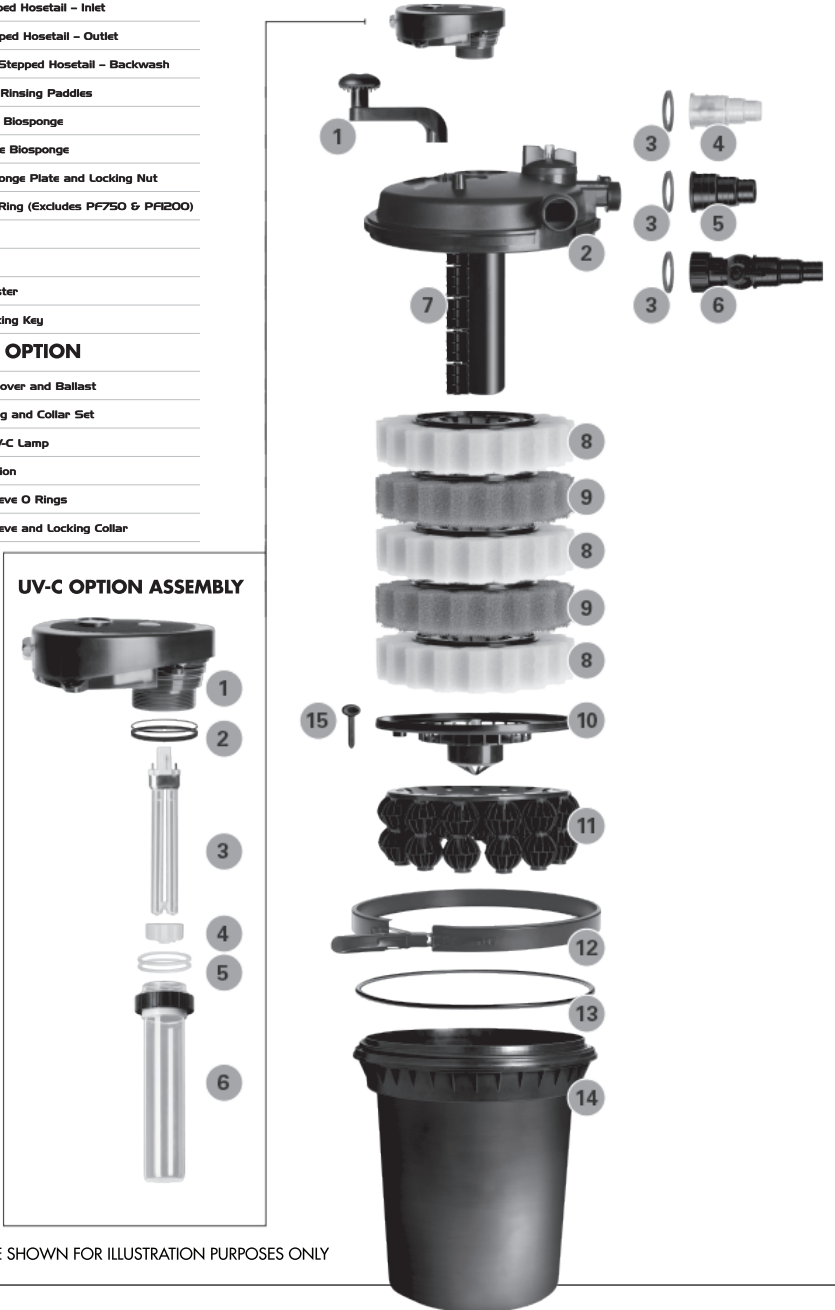

PF2400 IMAGE SHOWN FOR ILLUSTRATION PURPOSES ONLY