

should consult an electrician before using the power point again.

- Always use a properly grounded power supply that is connected to an RCD with a rated residual operating current not exceeding 30mA. As per AS/NZS 3350.2.41:1997.
- Always unplug the pump from the power supply when not in use or before performing any maintenance on the pump. Never pull the cord to disconnect the plug from the power supply. Grasp the plug and pull to disconnect.
- Do not install or store the pump where it will be exposed to extreme hot or cold temperatures.
- Keep out of reach of children or pets. This appliance should not be used by children or infirm persons without supervision.
- Do not cut the cord as this will result in voiding your warranty.
- Care should be taken to arrange the power cord so that it cannot be accidentally tripped over or pulled.
- Do not attempt to repair the pump yourself. Return to an authorized service centre or place of purchase if a fault occurs (regular maintenance is not considered repair and is required by user).

### LIMITED WARRANTY 2+1 YEAR

The additional 1 Year Extended Warranty applies when you REGISTER with Aquatec Equipment. See enclosed for details and please retain your proof of purchase and Warranty form.

- Warranty covers only appliance defects and faulty material and workmanship within a 2 year period.
- Faults arising due to; accidents, misuse, not following manufacturer's guidelines/ instructions or power surges/spikes/ brownouts will not be covered.

- The impellor set is a consumable item and is therefore not covered under warranty.
- Warranty will be void if any tampering removal of warranty labels or electrical circuitry is evident.
- Warranty will be void if the power cord is cut or damaged in any way.
- Warranty will be void if any visible signs of overheating are present.
- Loss of livestock, damage to property or personal injury caused by this product will not be covered.
- Warranty claims caused by installation faults will not be covered.
- It is the customer's responsibility to return the faulty appliance for any warranty claim, to Aquatec.
- For any warranty to be valid, an original proof of purchase must be provided.

### EXTENDED WARRANTY

- The Extended Warranty period is for an additional 1 Year and commences on expiration of the standard Warranty period.
- Application for Extended Warranty is FREE of any registration cost to the purchaser on completion of the Extended Warranty questionnaire can be found in the box with the item purchased or online at [aquatecequipment.com](http://aquatecequipment.com).
- Please keep a copy of the registration form in a safe place together with your proof of purchase (sales receipt). Both documents will be required for any claim under this extended warranty.
- Where Aquatec determines goods are being used in a manner contrary to the instructions, specifications or this Warranty, Aquatec reserves the right to terminate Extended Warranty for such goods and will provide written notice to the purchaser.



## FILTER HIGH FLOW PUMP



## INSTRUCTION MANUAL

Manufactured for:

**AQUATEC**  
EQUIPMENT

PO Box 648, Maddington, WA, 6989

Telephone: 1300 55 22 02

Email: [info@aquatecequipment.com](mailto:info@aquatecequipment.com)

Web: [www.aquatecequipment.com](http://www.aquatecequipment.com)

# PondMAX

## FILTER HIGH FLOW PUMP

	PH30000	PH55000
VOLTAGE (V)	240	240
POWER (WATTS)	230	700
MAX HEAD(M)	4.8	8.2
MAX FLOW (L/H)	30000	55000
OUTLET	100mm	100mm

### DESCRIPTIONS AND FEATURES

Your Pondmax pond pump has been manufactured with advanced technology to provide you with the best quality pump for your pond or water feature.

- Pondmax pumps are suitable for use in many different applications including; fountains, water features, small ponds and hydroponics.
- Your Pondmax pump has a single moving part (an impellor set) therefore enabling easy cleaning and maintenance.
- The motor and electrical components are encapsulated in epoxy resin, ensuring safe operation under water.
- The pump has a robust bearing and shaft design so no oil/grease lubrication is required.
- The Pondmax pumps that have plastic encased impellor parts and ceramic shafts (no exposed metal) may be used in salt water applications.

### INSTALLATION

1. If required, have a qualified electrician install weatherproof power point near to the pond or water feature (within the cable length of the pump).
2. Place the pump in desired location and connect pipework to the outlet.
3. Ensure pump is submerged, then plug in power cord and switch on.

### MAINTENANCE

Disconnect power cord from the power supply before performing maintenance. Never lift the pump by the power cord.

The only serviceable item is the impellor set.

The motor unit of the pump is encapsulated with epoxy resin and does not need lubrication.

All Pondmax submersible pumps are water cooled; if pump becomes restricted it will overheat and could cause permanent damage. Ensure pump does not become blocked or restricted.

The power cord cannot be replaced. If the cord is damaged, the pump must be discarded.

The impellor set is a wearing consumable part. Regular inspections, cleaning and maintenance of impellor is necessary to ensure longer impellor life.

If the impellor set becomes worn or damaged it should be replaced (available from your dealer or special orders). Failure to do so may cause serious damage to pump.

1. Disconnect the power cord from the power supply before performing maintenance.
2. Remove from water, detach pipe work.
3. Unscrew the main casing by unscrewing the screws around the outside of the casing, and remove.
4. Unscrew the 4 screws holding the motor to the base. Gently remove the motor and remove the impellor out of the motor.
5. Clean impellor, checking for any signs of wear or damage. Check the inside of the motor for signs of wear or damage.
6. Reinsert the impellor into the motor and hold in while relocating on the base. Ensure o'ring is seated properly and tighten screws evenly, ensuring impellor is seated properly.

7. Replace power cord into slot in base and replace main casing. eplace screws making sure they are done up evenly.
8. Re-attach pipework, submerge in water and turn on.

### IMPORTANT SAFEGUARDS

To guard against injury, basic safety precautions should be observed including, but not limited to the following;

- The pump should only be used in clean water. Do not use the pump in any solvent or liquid that is flammable.
- Do not operate the pump without water at any time, permanent damage may occur.
- Do not operate the pump if the pump, or any of the components of the pump such as the power cable, have been damaged.
- The drip loop method should be used to prevent water from traveling down the cord onto the plug or power point. If the plug does get wet, do not unplug the cord. Disconnect the circuit breaker that supplies power to the power point. Then unplug and examine the plug and power point for presence of water. If the power pOint has become wet, you

1. Base & Impellor Housing
2. Top Cage Section (with handle)
3. Outlet/Pump Housing
4. O'Ring
5. Impellor
6. Motor Body

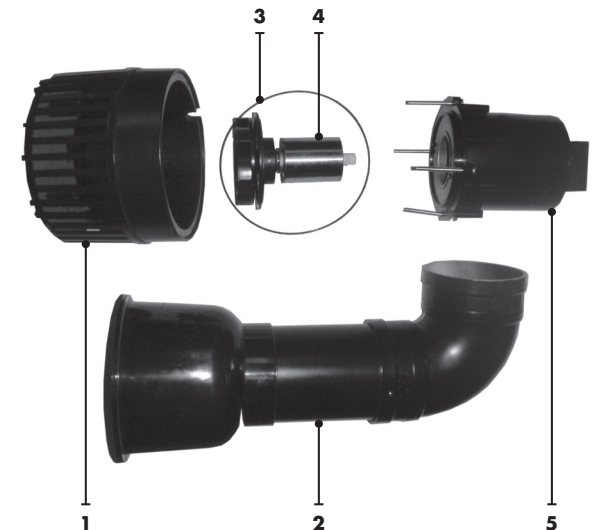

PH30000 Model shown, Picture for illustration purposes only.