

IMPORTANT SAFEGUARDS

To guard against injury, basic safety precautions should be observed including but not limited to the following;

- The pump should only be used in clean water. Do not use the pump in any solvent or gasoline that is flammable.
- Do not operate the pump without water at any time, permanent damage may occur.
- Do not operate the pump if the pump or any of the components of the pump such as the power cable have been damaged.
- If the plug does get wet, do not unplug the cord. Disconnect the circuit breaker that supplies power to the power point. Then unplug and examine the plug and power point for presence of water. If the power point has become wet, you should consult an electrician before using the power point again.
- Warning: Always use a properly grounded power supply that is connected to an RCD with a rated residual operating current not exceeding 30mA. As per AS/NZS 3350.2.41:1997
- Always unplug the pump from the power supply when not in use or before performing any maintenance on the pump or in the pond. Never pull the cord to disconnect the plug from the power supply. Grasp the plug and pull to disconnect.
- Do not install or store the pump where it will be exposed to extreme hot or cold temperatures.
- Keep out of reach of children or pets. This appliance should not be used by children or infirm persons without supervision.
- Do not cut the cord as this will result in voiding your warranty.
- Care should be taken to arrange the power cord so that it cannot be accidentally tripped over or pulled.
- Do not attempt to repair the pump yourself. Return to an authorized service centre or place of purchase if a fault occurs.
- Do not use in water above 35°C.

WARRANTY AGAINST DEFECTS

This product comes with a warranty against defects and motor failure (Warranty). The benefits provided in this Warranty are in addition to other rights and remedies available to you under the Australia Consumer Law. The Warranty is provided to the original purchaser of the product on the following terms:

- The Warranty is given by Chemkay Pty Ltd trading as Aquatec Equipment: Po Box 2087, Seville Grove, WA 6112; contactable by phone (1300 552 202) or email (info@aquatecequipment.com).
- To make a claim under the Warranty you must return the faulty product to the place of purchase with a valid receipt or proof of purchase.
- A Warranty claim must be made within 2 years of the date of purchase.

- If your claim complies with the above terms and the product is not an Exhaustable Item and no Voiding Events have occurred, we will (at our sole discretion):
 - repair the product, if possible; or
 - provide a replacement product; or
 - if a replacement product is not available, provide a refund for the purchase price paid.
- You will bear the cost associated with claiming under the Warranty such as the cost of transportation and delivery of the product to and from the place of purchase.
- The product contains a complete impellor set and O ring. These items are exhaustable (Exhaustable Items) and are not covered under the Warranty.
- The Warranty will be void if any of the following events occur, as determined by us, at our sole discretion (Voiding Events):
 - any tampering/removal of warranty/identification labels or electrical components is evident;
 - the defect has arisen due to: an accident, incorrect or inadequate installation, misuse or abuse of the product (including improper maintenance and service), excessive wear and tear, not following manufacturer's guidelines/instructions, or the product has been used in a manner contrary to the purpose or suitability of the product;
 - the product has been modified without our authority;
 - the defect is caused by power surges/spikes/brownouts.
- Loss of livestock, damage to property or personal injury caused by the improper use or abuse of the product will not be covered and the manufacturer excludes all liability for such events, to the extent permitted by law.
- In addition to the Warranty set out above, our goods come with guarantees that cannot be excluded under the Australian Consumer Law. You are entitled to a replacement or refund for a major failure and for compensation for any other reasonably foreseeable loss or damage. You are also entitled to have the goods repaired or replaced if the goods fail to be of acceptable quality and the failure does not amount to a major failure.

EXTENDED WARRANTY

- The Extended Warranty period is for an additional 1 Year and commences on expiration of the standard Warranty period.
- Application for Extended Warranty is FREE of any registration cost to the purchaser on completion of the Extended Warranty questionnaire can be found in the box with the item purchased or online at aquatecequipment.com.
- Please keep a copy of the registration form in a safe place together with your proof of purchase (sales receipt). Both documents will be required for any claim under this extended warranty.
- Where Aquatec determines goods are being used in a manner contrary to the instructions, specifications or this Warranty, Aquatec reserves the right to terminate Extended Warranty for such goods and will provide written notice to the purchaser.

E.&O.E.

PondMAX

- ULTRA SERIES - POND & FOUNTAIN PUMPS



INSTRUCTION MANUAL



AQUATEC
EQUIPMENT

1300 552 202
www.aquatecequipment.com

PondMAX

– ULTRA SERIES – POND & FOUNTAIN PUMPS

	PM1200F	PM2500F	PM4000F
MAXIMUM FLOW (L/H)	1200	2500	4000
MAXIMUM HEAD (m)	2.00	2.40	4.00
POWER (W)	25	50	100
VOLTS (V)	240	240	240
FREQUENCY (Hz)	50	50	50
INLET Ø BSP (mm)	15	25	25
OUTLET Ø BSP (mm)	15	15	15
CABLE LENGTH (m)	10	10	10

DESCRIPTION AND FEATURES

Your PondMAX pond pump has been manufactured with advanced technology to provide you with the best quality pump for your pond or water feature.

- PondMAX pumps are suitable for use in many different applications including fountains and water features, either submersible or inline.
- PondMAX pond & fountain pumps are a centrifugal design and magnetically driven. They are to be operated submerged, or in-line with flooded suction only. Do not run the pump without water flow, block or prevent rotation of the impellor as this will cause possible burn out and void warranty.
- Your PondMAX pump has a single moving part (an impellor set) therefore enabling easy cleaning and maintenance.
- The motor and electrical components are encapsulated in epoxy resin, ensuring safe operation under water.
- The pump has a robust bearing and shaft design so no oil/grease lubrication is required.
- The PondMAX pumps that have plastic encased impellor parts and ceramic shafts (no exposed metal) may be used in salt water applications.

- PondMAX fountain pumps are fitted with suction cup feet, enabling use on both horizontal and vertical surfaces.

INSTALLATION

1. If required, have a qualified electrician install weatherproof power point near to the pond or water feature, (within the cable length of the pump).
2. Place the pump in desired location, ensure the pump is on a stable surface that is free of sludge, sand and other debris, and connect tubing to the outlet or attach fountain kit.
3. Ensure pump is submerged or properly installed inline, then plug in power cord and switch on.

MAINTENANCE

Disconnect power cord from the power supply before performing maintenance. Never lift the pump by the power cord.

The only serviceable item is the impellor set.

The motor unit of the pump is encapsulated with epoxy resin and does not need lubrication.

All PondMAX submersible pumps are water cooled; if pump becomes restricted it will overheat and could cause permanent

damage. Ensure pump does not become blocked or restricted.

The power cord cannot be replaced. If the cord is damaged, the pump must be discarded.

The impellor set is a wearing consumable part. Regular inspections, cleaning and maintenance of impellor is necessary to ensure longer impellor life.

If the impellor set becomes worn or damaged it should be replaced (available from your dealer or special orders). Failure to do so may cause serious damage to pump.

1. Disconnect the power cord from the power supply before performing maintenance.
2. Remove from water, detach tubing/ fountain kit and remove front cage or foam prefilter from pump.
3. If using a prefilter block sponge, slide the sponge off the threaded core and wash out in a bucket of pond or dechlorinated water. If you are using the internal sponge that comes with the pump, take it out of the cage and wash it out as above.
4. Remove the impellor cover by turning clockwise and pulling out (it may be quite

stiff due to algae and grime build up).

Gently remove the impellor and shaft, use long nose pliers if needed. Take care not to break ceramic shaft (if applicable) because they are brittle.

5. Clean the impellor with a brush, checking for any signs of wear or damage. If impellor/ shaft are damaged or broken, replace immediately. If pump is run with a damaged impellor, permanent damage may occur.
6. Reinstall the shaft, and then carefully slide the impellor onto the shaft. The impellor will pull itself in by magnetic force, this is normal (take care not to pinch your fingers or break the shaft).
7. Replace the impellor cover, making sure the shaft is located properly on the impellor cover. You may need to place rubber impellor locator on end of shaft to locate in impellor cover properly.
8. Replace the internal sponge and front cage or foam prefilter.
9. Re-attach tubing/fountain kit, submerge in water, connect to power supply and turn on.

1. Front Cover
2. Biosponge Filter
3. Intake Screen
4. Impellor Cover
5. Impellor & Ceramic Shaft
6. Motor Body
7. Extendable Riser
8. Bell Nozzle
9. Daisy Nozzle
10. Pump Adaptors
11. Inlet Adaptor*
12. Flow Controller with Waterfall Outlet
13. Flow Controller Adaptor

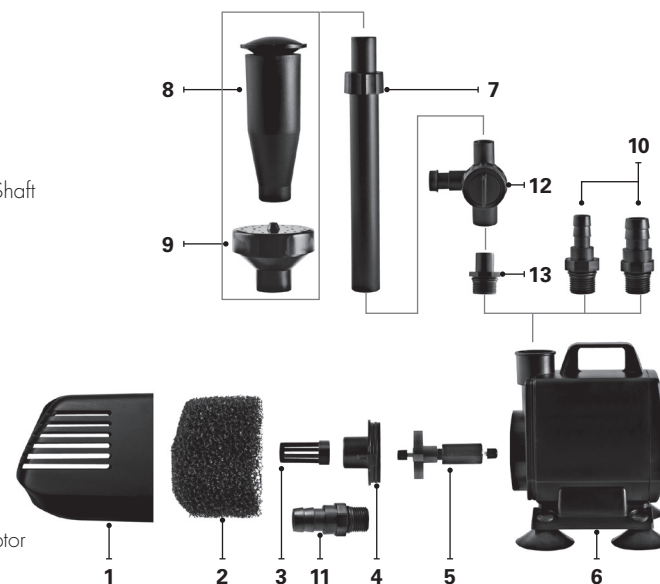

Exploded View of Pump

*For non-submersible applications